

## CVP0.M28 Valve Series

**METRIC Cartridge - 300 bar**

**Direct acting - Poppet Type**

### Description

A screw-in, cartridge style, direct acting, poppet type check valve. Main use is as a blocking or load-holding device.

The CVC5.S08 allows flow passage from port 1 to 2: the cartridge has a fully guided check which is spring-biased closed until sufficient pressure is applied at port 1 to open to 2

The flow is blocked in the opposite direction (2 to 1).

### Technical Features

All external surfaces are zinc plated and corrosion-proof.

All valve parts are made of high strength steel. Poppet is hardened and ground to guarantee minimal wear and to extend service life.

Compact size.

Optional bias springs for back-pressure application flexibility.

Metric cavity.



## Symbols



## Performance Details

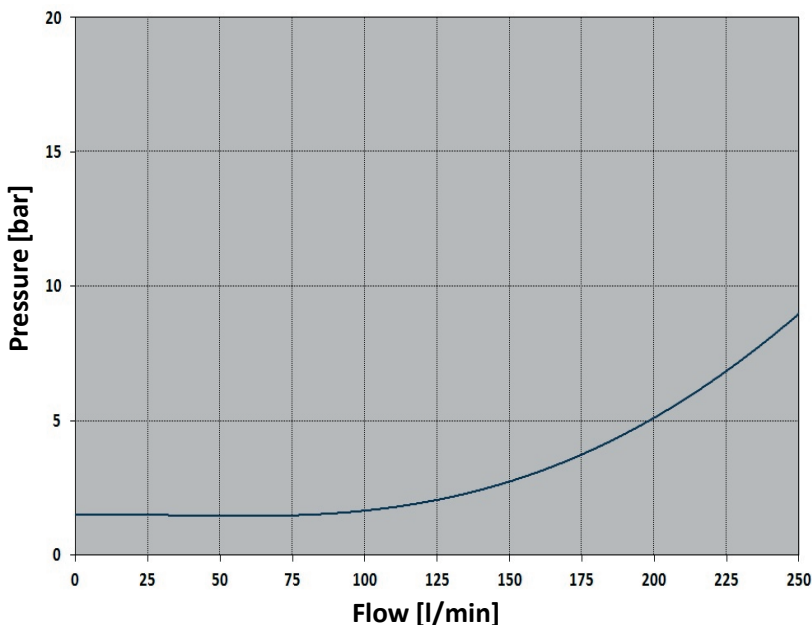

### Technical Data

Maximum operating pressure: 300 bar

Maximum flow: 250 l/min

Internal leakage: 0.10 cc/min max @ 300 bar

Temperature: -30°C to 110°C

Fluids: Mineral-based or synthetics with lubricating properties at viscosities of 7.4 to 420 cSt

Orientation: no restrictions

Installation torque: 90-100 Nm

Seal kit code: SK.050

Weight: 0.235 kg

NOTE: The performance chart illustrates flow handling capacity.

P/Q curve is recorded at  $T_{oil} = 40^{\circ}C$  and 46 cSt

## Cross Section

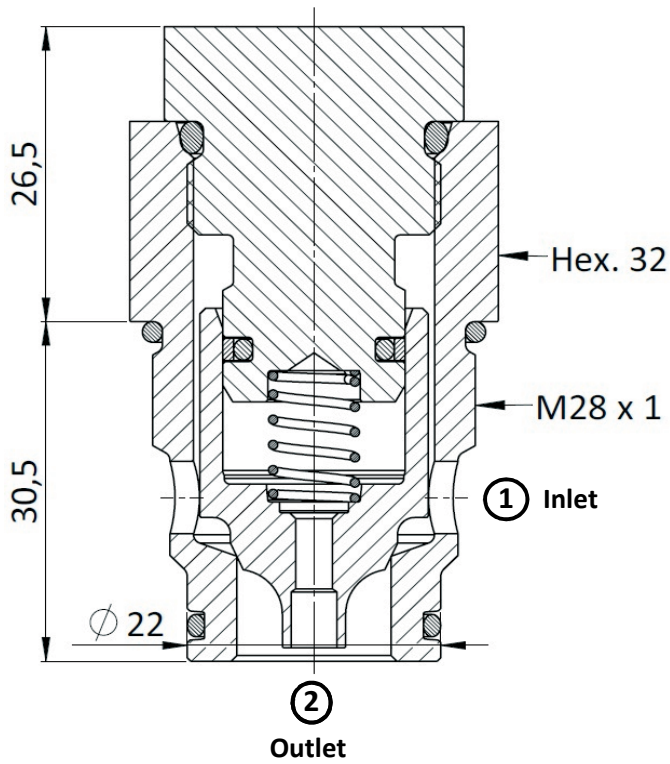

## Cavity Details

VH091

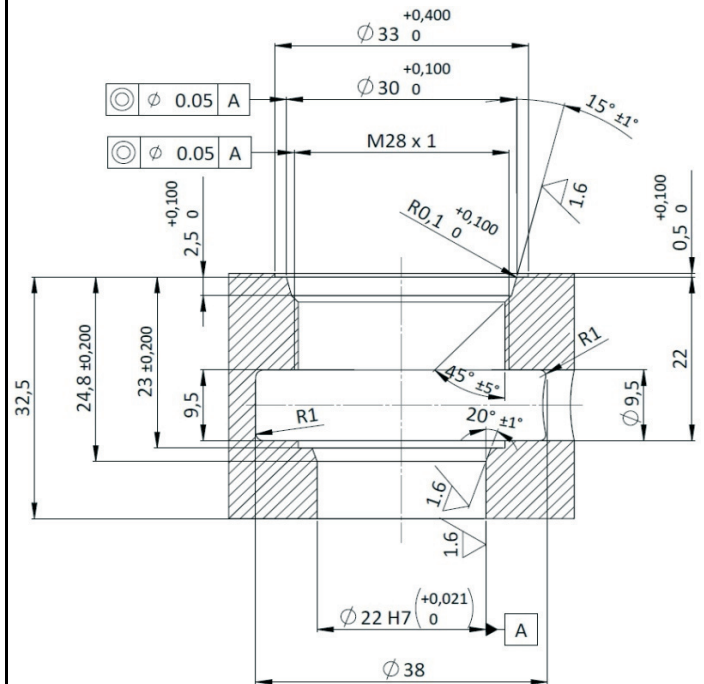

See Page 290

## Ordering Code

**C** **V** **P** **0** . **M** **2** **8** . **0** **N** . **0** **0** **0**

Valve Basic Code

**Cavity**  
**M28** = Metric M28 x 1  
 UNF cavity available  
 upon request

**000** = standard configuration

**Bias Spring** **N** = standard (cracking pressure < 2 bar)

**Marking** **0** = Standard factory marking  
 Customized markings can be done upon request

Customized bias springs can be  
 offered upon request.